

RoHS2.0
Compliant

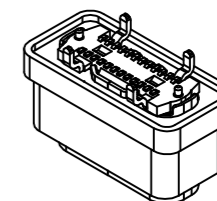
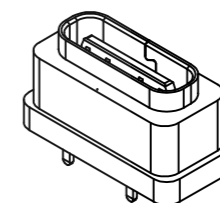
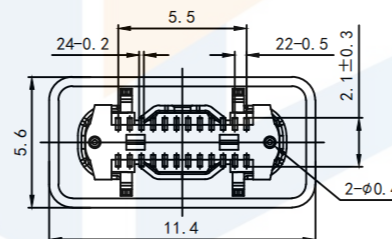
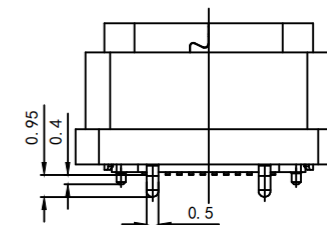
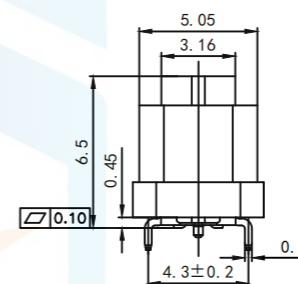
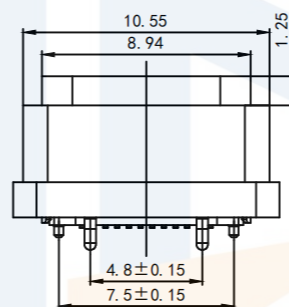
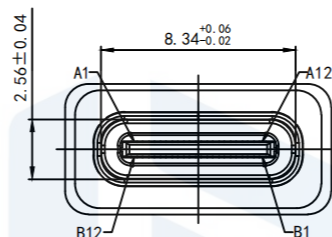
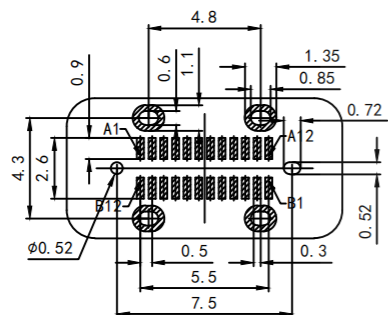
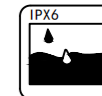

RECOMMEND P. C. B LAYOUT (COMPONENT SIDE)
TOLERANCE FOR PCB LAYOUT IS ± 0.05

NOTE:

1. MECHANICAL PERFORMANCE

1-1. INSERTION FORCE: 0.5~2.0kgf.

1-2. EXTRACTION FORCE: 0.8kgf~2.0kgf 0.6kgf~2.0kgf.

AFTER DURABILITY TEST.

1-3. DURABILITY: 10000 CYCLES.

2. ELECTRICAL PERFORMANCE,

2-1. CURRENT RATING: 5.0A

VOLTAGE RATING: 5.0V

2-2. LLCR:

VBUS & GND PINS AND OTHER PINS: 40mΩ/PIN

MAXSHIELD: 50m2/MAX. LLCR MAX, CHANGE OF ALL PINS: 10m2.

2-3. INSULATION RESISTANCE: 100M2MIN

2-4. DIELECTRIC WITHSTAND VOLTAGE, AC 100V FOR 1

MINUTE3. ENVIRONMENTAL PERFORMANCE: OPERATING

TEMPERATURE: -25°C~+85C.

4. IR REFLOW:

THE PEAK TEMPERATURE ON THE BOARD SHALLBE MAINTAINED

FOR 10 SECONDS AT 260°C.

TOLERANCE

X. XXX	± 0.05
X. XX	± 0.15
X. X	± 0.20
X.	± 0.30
ANGLE	$\pm 5.0^\circ$

PROTECTON

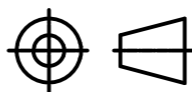

东莞市恒祺电子科技有限公司

Dongguan Hengqi Electronic Technology Co., Ltd

<https://www.hq-dz.com>

phone: 15812872448

TITLE:

TYPE C 24P立贴防水母座H=6.5

PART NO: TYPE-C24P-FSL65

DRAWING NO: 11.4*5.6*5.05

DRAWN:

CHECKED:

APPROVED:

DATE:

DATE:

DATE:

18-10-08

18-10-08

18-10-08

UNIT:
mm

SCALE:
FULL

SIZE:
A4