

RoHS2.0
Compliant

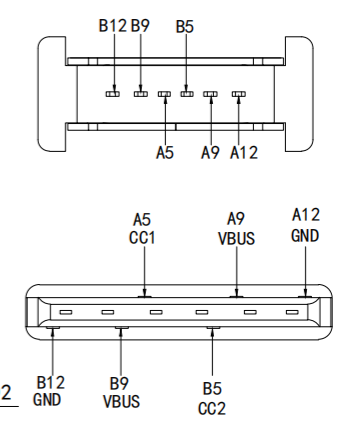
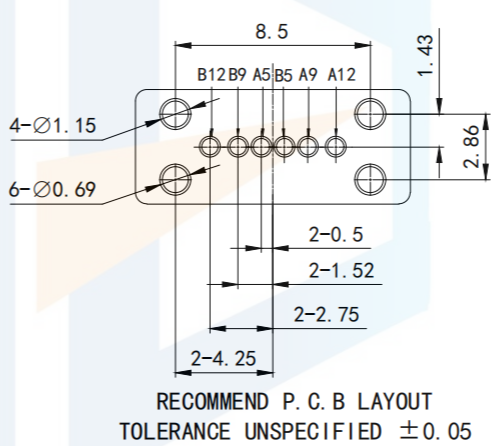
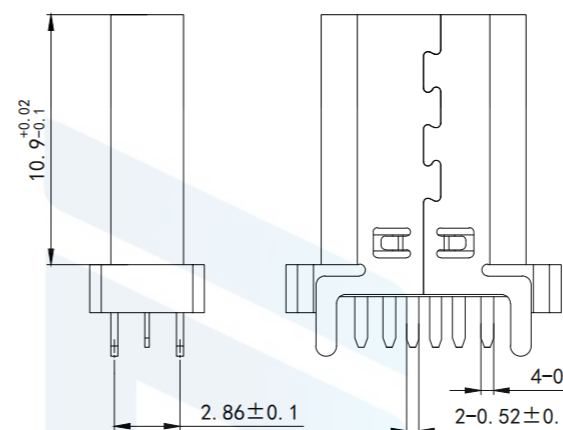
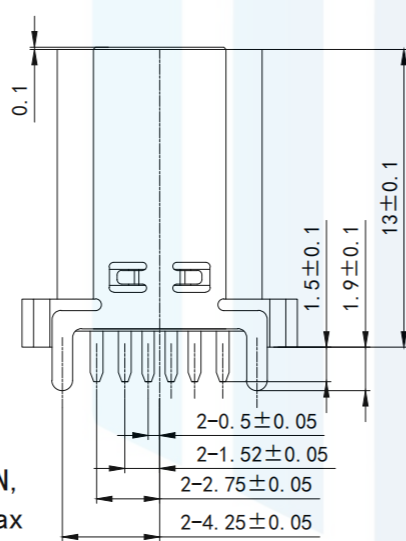
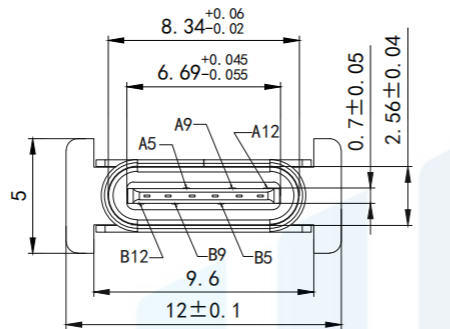

Pin	SignalName	MatingSequence	Pin	SignalName	MatingSequence
A1			B12	GND	First
A2			B11		
A3			B10		
A4			B9	VBUS	First
A5	CC1	Second	B8		
A6			B7		
A7			B6		
A8			B5	CC2	Second
A9	VBUS	First	B4		
A10			B3		
A11			B2		
A12	GND	First	B1		
SHELL	GND		SHELL	GND	

NOTES :

Attributes: Specifications
Electrical:

Contact impedance: the initial maximum is not more than 40m2Max, and the change value after the test is not more than 10m2Max

Withstand voltage: AC200V 60S/MIN, 0.5mA Max; DC500V.60S/MIN, 100QMax

Insulation resistance: 100MohmsMIN

Rated current: 2A MAX

Rated voltage: 10VMAX

Material: Material:

Molding: LCP black

high-temperature resistant plastic

Terminal: C2680 T=0.20mm

Housing: SUS201 1=0.30mm

Plating Specifications:

Terminals: Half gold tin, contact point gold plating 1U", matte tin plating at wire bond 40-80U"

Shell: nickel plated 80u" environmental protection

requirements: ROHS, REACH standard

TOLERANCE	X. XXX	±0.05		东莞市恒祺电子科技有限公司 Dongguan Hengqi Electronic Technology Co., Ltd		
	X. XX	±0.15		https://www.hq-dz.com phone:15812872448		
PROTECTON 	X. X	±0.20	TITLE: TYPE C 6P立式直插基座加高		PART NO:TYPE-C6P-LCA113	
	X.	±0.30	DRAWING NO:13*12*3.06			
	ANGLE	±5.0°	DRAWN:	DATE:	18-10-08	UNIT: mm
			CHECKED:	DATE:	18-10-08	SCALE: FULL
			APPROVED:	DATE:	18-10-08	SIZE: A4